

# 97000 Mini Refrigerated Display Cases



Shown with Optional Front Closing Doors, Mirrored Ends and HPL Exterior

- Tempered, Insulated, Glass Front & Top
- Insulated Glass Ends
- Framed, Sliding, Insulated, Tempered Glass Doors (Hinged Door 31"L)
- Top Light with Lamp & Shield
- White Wire Shelves (40" H-2) (48" H-3)
- Heavy-Duty Deck - White Finish
- Heavy Duty Steel Base - Black Finish
- Rear Grille
- Self-Contained Air Cooling Unit in Base
- Removable for Ease of Maintenance & Cleaning (36" Long and 40" Long)
- 120 Volts - 60 Cycle - Single Phase
- 1/3 HP - 10 amps
- 1/4 HP - 10 amps (31"L)
- Automatic, Energy Saving, Condensate Evaporator
- 10' Cord, Plug & Switch
- U.L. & C.U.L. Listed
- "ETL" Sanitation Listed (Conforms to NSF STD-7)



# 97000 Mini Refrigerated Display Cases

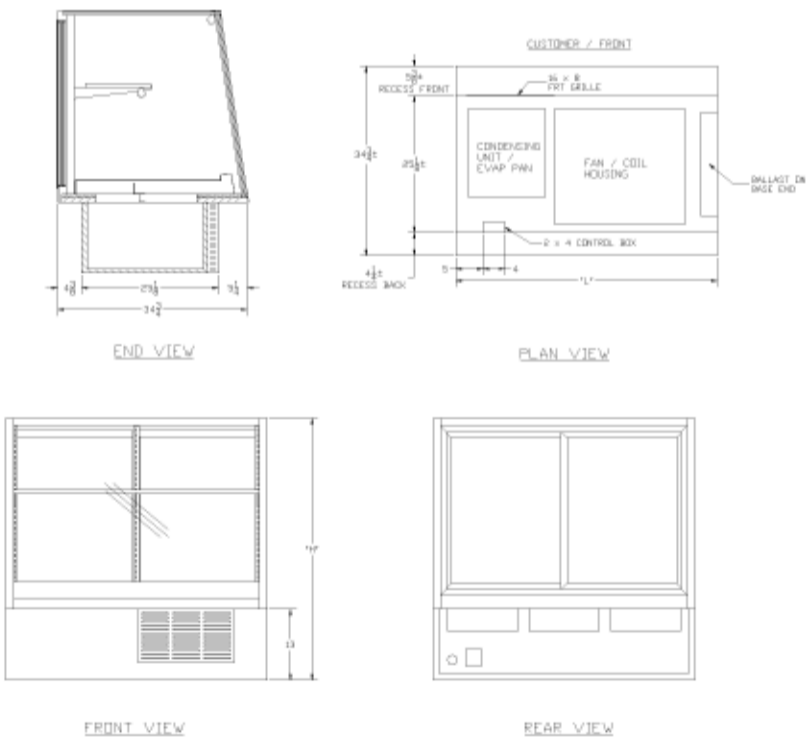

Model No.	Dimensions: L X W X H	Rows of Shelves	Est. Crated Weight	Case Options:
97040-36R	36" X 34 3/4" X 40"	2	530 lbs.	1. Mirror Ends 2. Mirror Doors 3. Side Lights, Lamps and Shields 4. HPL Finish Cover Front and Ends (Standard HPL) 5. Self Closing Front Doors 6. Brasstone, Black, or White Finish (Frame & Lights Only) 7. 4-YR Extended Motor/Compressor Parts Warranty
97040-40R	40" X 34 3/4" X 40"	2	540 lbs.	
LV9704831R	31" X 30" X 48"	3	530 lbs.	
97048-36R	36" X 34 3/4" X 48"	3	540 lbs.	
97048-40R	40" X 34 3/4" X 48"	3	550 lbs.	

Specifications Subject to change without notice

