

94000 Series

Lift Up Double Curved Front Non-Refrigerated Display Cases



Features & Finishes:

- Lift Up Double Curved Front Glass Single Pane
- Solid Work Surface
- Aluminum Framed, Sliding Mirror Doors
- Top Light & Shelf Lights with Lamps & Shields
- White HPL Deck
- White Wire Shelves, 7-1/2° Slanted (2-24"W & 1-18"W)
- Mirror Ends
- White Interior HPL Finish
- 12" Cord, Plug & Switch
- U.L. & C.U.L. Listed



94000 Series

Lift Up Double Curved Front Non-Refrigerated Display Cases

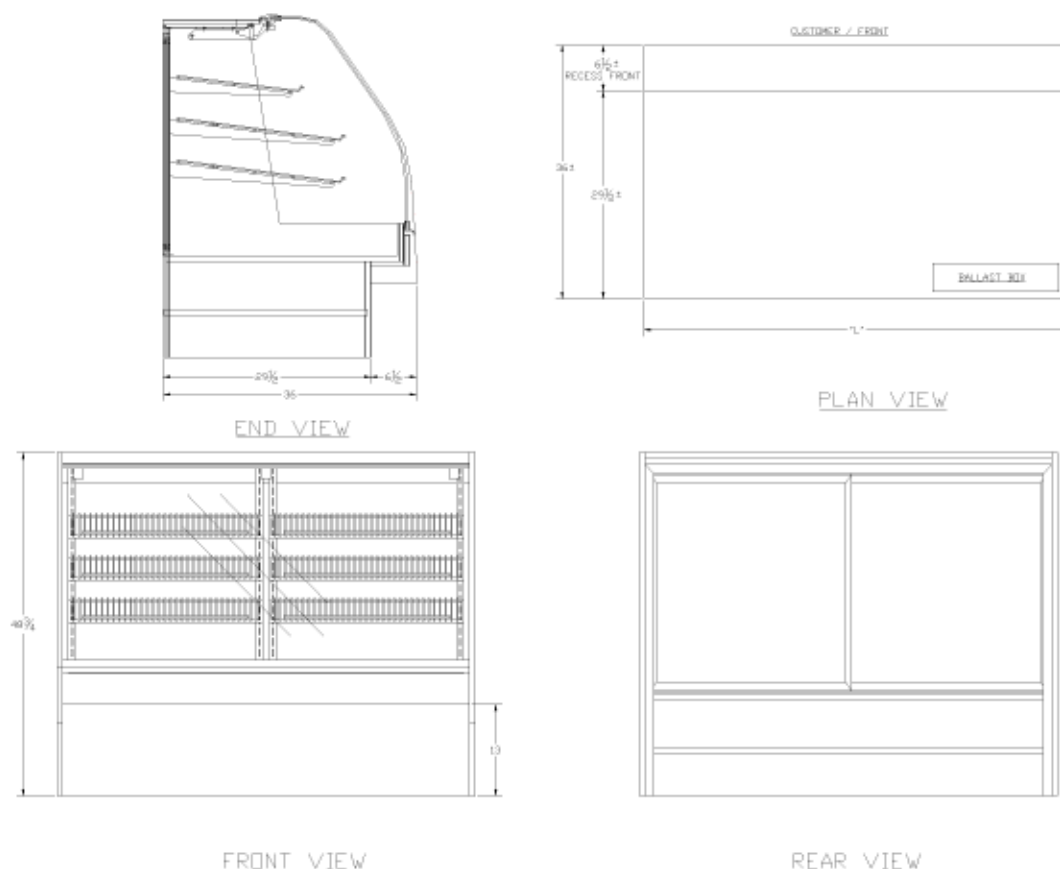

FRONT VIEW

REAR VIEW

Model No.	Dimensions: L X D X H	Rows of Shelves	Est. Crated Weight	Case Options:
94048-48	49 1/2" X 36" X 48 3/4"	3	510 lbs.	1. "ETL" Sanitation Listed (Conforms to NSF - STD - 2) 2. Transparent Mirror Doors 3. Vented Doors 4. Package Ledge 5. Std. HPL Exterior Finish 6. Remote Compressor (Shipped Separately) 7. Casters or Legs (Adds 7 1/2" to Total Height)
94048-59	60 1/2" X 36" X 48 3/4"	3	550 lbs.	
94048-77	78 1/2" X 36" X 48 3/4"	3	635 lbs.	

Specifications Subject to change without notice

