

# 91000 Series Non-Refrigerated Bakery Display Cases



## Features & Finishes:

- Anodized Aluminum Frame
- Curved Front Glass
- Top Light with Lamp & Shield
- Shelf Lights with Lamps & Shields (48", 59", 77")
- Glass Ends & Top
- Aluminum Framed Sliding Glass Doors
- White Wire Shelves (40" H-2)(48"H-3)
- Open Rear Storage
- White HPL Deck
- White Interior Storage
- Black HPL Base
- 12" Cord, Plug, & Switch
- U.L. & C.U.L Listed



# 91000 Series Non-Refrigerated Bakery Display Cases

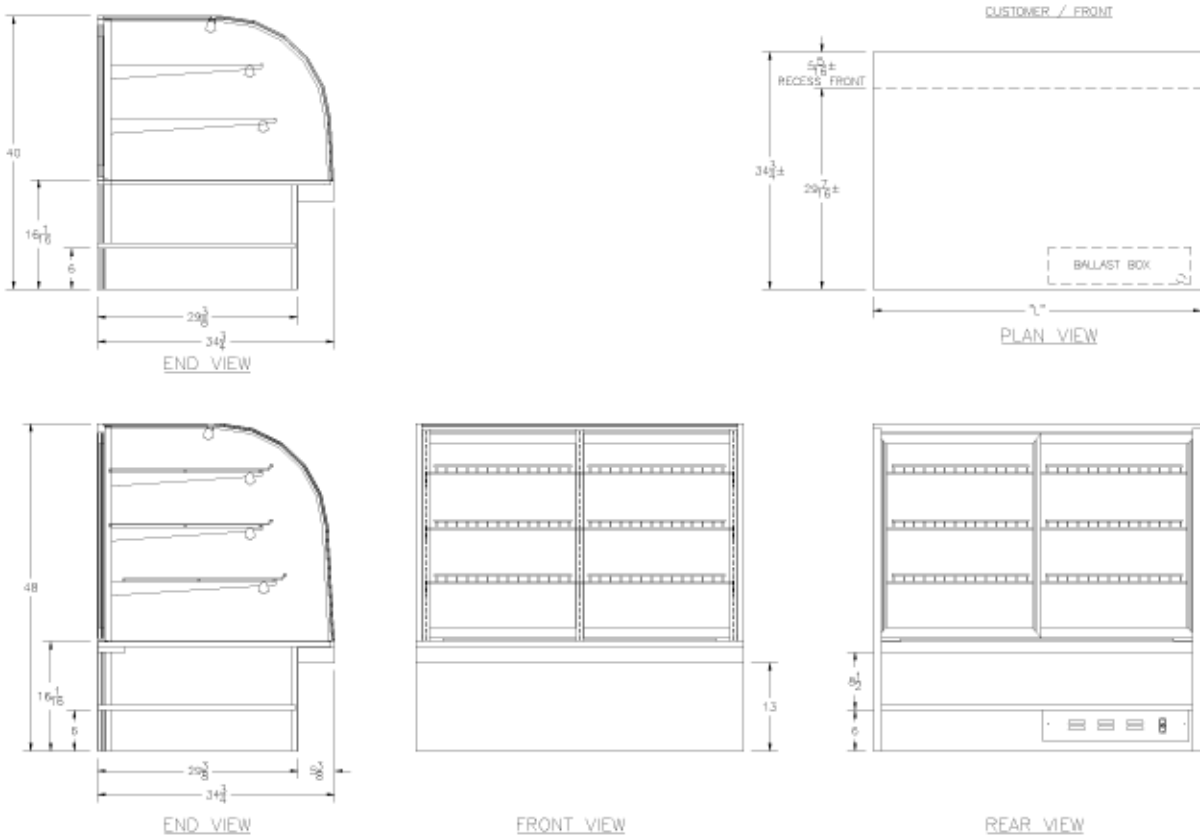

Model No.	Dimensions: L X D X H	Rows of Shelves	Est. Crated	Pan Capacity	Case Options:
91040-36	36" x 34 3/4" x 40"	2	350 lbs.	9 Half	1. "ETL" Sanitation Listed (Conforms to NSF STD-2) 2. Brasstone or Black Finishes (Frame & Lights Only) 3. Mirror Doors 4. Transparent Mirror Doors 5. Vented Doors 6. Std. HPL Finish Base 7. Mirror Ends 8. Remote Compressor (Shipped Separately) 9. Casters or Legs (Adds 7 1/2" to Total Height)
91040-48	48" x 34 3/4" x 40"	2	495 lbs.	6 Full	
91040-59	59" x 34 3/4" x 40"	2	510 lbs.	9 Full	
91040-77	77" x 34 3/4" x 40"	2	595 lbs.	12 Full	
		3			
91048-36	36" x 34 3/4" x 48"	3	370 lbs.	12 Half	
91048-48	48" x 34 3/4" x 48"	3	520 lbs.	8 Full	
91048-59	59" x 34 3/4" x 48"		540 lbs.	12 Full	
91048-77	77" x 34 3/4" x 48"		625 lbs.	16 Full	

Specifications Subject to change without notice

